

1411-S Kitchen Sink

1411-S Single Bowl

I.D.: 13 3/4" x 10 3/4"

Depth: 6 1/8"*

*Depth does not include counter top thickness

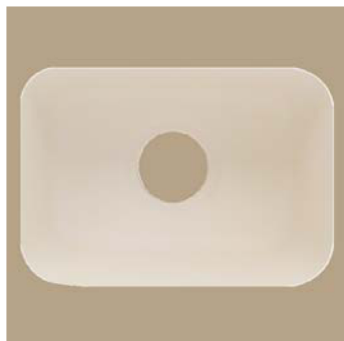

The 1411-S Single Bowl Kitchen Sink provides a seamless utility sink in any solid surface sheet material, acrylic, polyester or blended. This sink fits well in a tight places or in any situation where a small, rectangular sink is required, including residential, clinical, or other commercial uses. This sink can be installed in either direction.

1411-S Sinks are compatible and warranted when used with all major solid surface sheet brands with the same sheet warranties.

 Sink manufacturer supports conservation and green building practices and may contribute toward achieving LEED® building certification in commercial projects. All Sinks use resin containing 15% post-consumer recycled content and 5.5% rapidly renewable materials.

 Sinks proudly made in the USA.

Sinks are certified by: **NAHB** (ANSI Z124.3)

UL in the US and Canada (ANSI Z124.3 & B45.0-99)

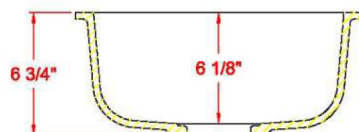
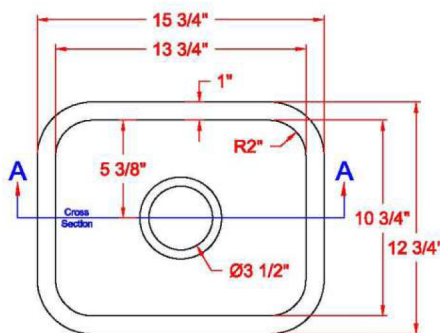

Section A-A
1411-S

